

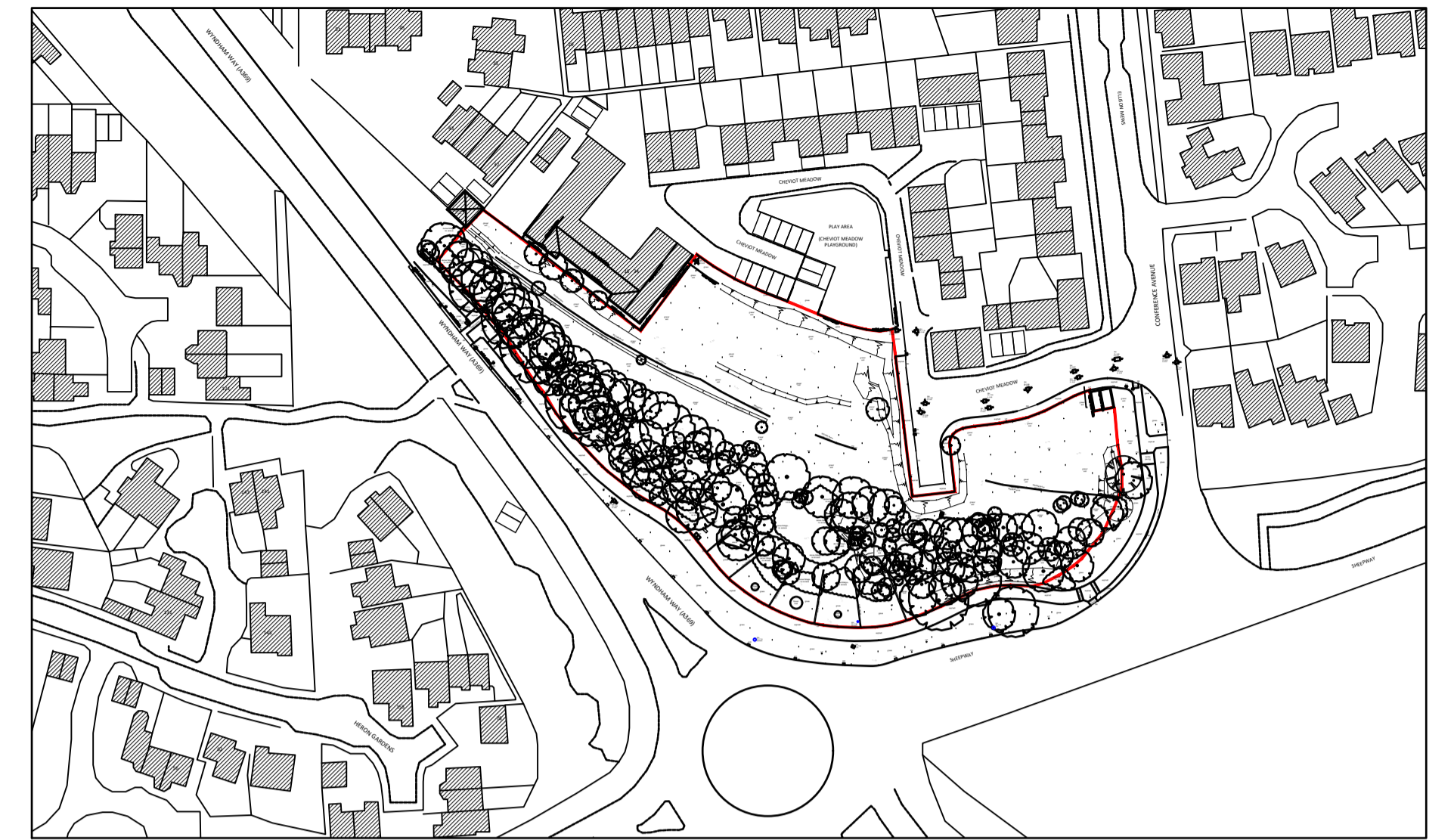

A-887 PORTISHEAD, BRISTOL
SITE PLAN 1:500@A1

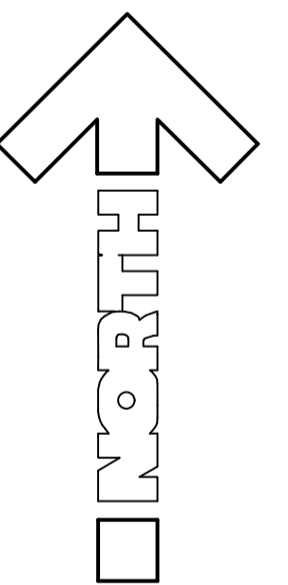

A-887 PORTISHEAD, BRISTOL
BLOCK PLAN 1:1250@A1



P3	SURVEY INFO ADDED	CJ	PK	13.11.20
P2	MINOR AMENDMENTS	CJ	PK	07.09.20
P1	FIRST ISSUE	CJ	PK	02.09.20

Rev.	Description	Author	Checked	Date
------	-------------	--------	---------	------

CARLESS + ADAMS

www.carless-adams.co.uk

6 Progress
Business Centre,
Whittle Parkway,
Slough, SL1 6DQ
tel: 01628 665131

Client
LeoDeansgate

Project
Portishead, Bristol

Title **Block plan** C+A no.
A-887

scale 1:1250 author CJ chkd PK date Nov. 12, 20 sheet size A1

project.	org.	zone.	level.	type.	role.	class.	num.	status.	rev.
887	C+A				A	G1	00		P3



For construction purposes dimensions shall not be scaled & figured dimensions must be verified on site before work commences.
This drawing is Copyright ©